



INDUSTRIAL & COMMERCIAL PRODUCT GUIDE







TABLE OF CONTENTS

THE LARNEC® DIFFERENCE	5
LARNEC® INDUSTRIAL & COMMERCIAL RANGE	6
Sentry® 200 Semi-Solid Core Series	8
Sentry® 100 Solid Core Series	10
CUSTOM DOORS	12
SUPPLIED HARDWARE	14



MAKE
SURE
IT'S A
LARNEC[®]
DOOR.





THE LARNEC® DIFFERENCE



PROUDLY AUSTRALIAN MADE AND OWNED.

With manufacturing facilities in Metro & Regional Victoria, we are proud to be Australian Made. We source steel and timber from the best Australian mills and our doors are manufactured to the highest standards.

Larnec® is a family-owned Australian company with a keen focus on quality. We specialise in the manufacture of high quality pre-hung shed and garage doors.

Our **Sentry® Personal Access Door** range is a market-leading product, specifically designed by our passionate and experienced team of professionals and manufactured right here in Australia to the very highest standards – durable products, that are easy to install quickly – while maintaining our focus on providing quality, cost-effective solutions for our customers.

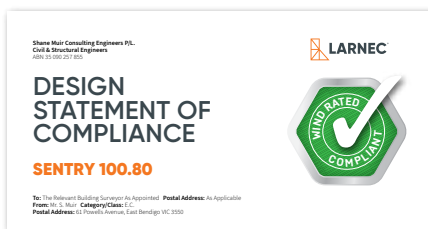

CERTIFIED WIND RATED

WIND RATED FOR **GENERAL PURPOSE**
REGIONS: A,B

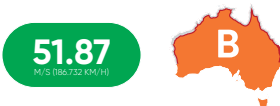

TESTED IN ACCORDANCE WITH AS/NZS 5555.2:2011

WIND RATED FOR **DOMESTIC**
CLASSIFICATION



TESTED IN ACCORDANCE WITH AS 4055-2012

The **Sentry® 200 series** features a semi-solid medium density polystyrene core with kiln-dried hoop pine sub-frame.

The premium **Sentry® 100 series** provides the same benefits and versatility of the 200 series, but with the added benefit of a solid kiln-dried hoop pine core – which provides heavy-duty security for your structures.

Sentry® Personal Access Doors are supplied with industrial quality Carbine locksets as standard – one of the most popular locksets across Australia and New Zealand. Built to Carbine's high quality and reliability standards, the leversets and knobsets are supplied in standard configurations for the industrial and commercial sector (knob/lever, lever/lever).

Sentry® doors are compatible with all leading lockset brands, with upgrades available, and can be provisioned with solutions for three-sided jamb, inwards-swinging doors and double door options.

Our fit-for-purpose **Sentry® 200** and **100** products are exceptionally strong and versatile, the perfect solution for a range of external applications, in either new or existing structures, such as:

- » Warehouses
- » Factories
- » Transport & Logistics facilities
- » Recreational facilities

The full range of **Sentry® Personal Access Doors** can be specified for your needs – with materials upgrades, lockset variations, and sizing modifications – to ensure your Larnec® door is perfect for your needs.

LARNEC® INDUSTRIAL & COMMERCIAL RANGE

Lar nec® has created a versatile range of solutions suitable for all your Industrial and Commercial external door needs.

Developed in consultation with industry experts, our market leading **Sentry® 100.80** and **Sentry® 200.80** range has been designed to easily adapt to multiple wall types, including timber stud walls, steel framework, and pre-cast panels.

The **Sentry®** range can be specified and ordered to suit various wall thicknesses. This range is the perfect solution for industrial warehouses, industrial sheds, factories, steel and precast concrete buildings.

The fit-for-purpose Tilt Panel **Sentry® 100.TP** or **Sentry® 200.TP** range has been specifically engineered for precast concrete buildings – and is the ideal retro-fit solution for an existing structure, as there is no need to precast the jamb.

Suitable for 100mm, 150mm or 200mm tilt panels with a +11mm /- 5mm tolerance with reversible handing and no external fixings, this door takes the complexity out of installation into precast concrete buildings.

The range can be specified with the option of a 3 or 4-sided jamb, and heavy-duty butt hinges, the popular **Sentry® 100.47** or **200.47** range can be tailored to suit your individual needs.

This product is a great solution for industrial warehouse and factory personal access doors and ideal for use in steel structures, such as Trimdek or Monoclad profiles.

Available in both standard and high sizes with a range of optional extras including:

- » J-mould weather flashing
- » Air relief grilles
- » Viewing panels
- » Door closers
- » Panic exit devices
- » Lockset upgrades
- » Electric striker preparation
- » Spring chain retainers
- » Latch guards
- » Seals

Available in the complete Classic & Contemporary ranges of **Colorbond®** steel colours or **Zincanneal®**, all our Industrial and Commercial products are customisable and come with a 2-year warranty for your peace of mind.

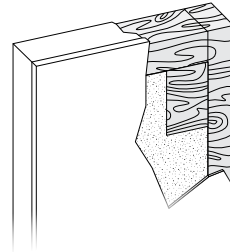

SENTRY® 200 DUAL SKIN SERIES

The semi-solid core for the **Sentry® 200 series** consists of medium density SL grade 35mm polystyrene surrounded by an internal sub-frame made of kiln-dried hoop pine. It includes hardware fixing points for the closer and lock blocks, is fully enclosed on faces and sides with two **Colorbond®** steel sheets, and fixed with a two-part polyurethane adhesive.

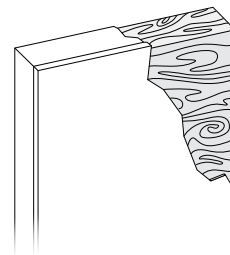

SENTRY® 100 SOLID CORE DUAL SKIN SERIES

The heavy-duty solid core for the premium **Sentry® 100 series** consists of a one-piece 35mm kiln-dried hoop pine insert. The metal-clad door leaf is dual skin, fully enclosed on faces and sides with two **Colorbond®** steel sheets, fixed with a two-part polyurethane adhesive.



SENTRY™ 200 SEMI-SOLID CORE RANGE 200.80 / 200.TP / 200.47

PRE-HUNG, FULLY METAL CLAD, SEMI SOLID CORE INDUSTRIAL DOOR FOR WAREHOUSES, FACTORIES & STEEL OR CONCRETE BUILDINGS.

The **Sentry® 200 series** is compatible with all leading hardware suppliers and configurable with a range of options and upgrades.

The **Sentry® 200 series** doors are a cost-effective solution for warehouses, factories and transport & logistics facilities. All doors in this series are manufactured with a medium density polystyrene core for enhanced thermal performance, pre-prepped for additional hardware and are wrapped in dual-skin **Colorbond®** or **Zincan Neal®** steel sheeting for added strength and security.

The multi-folded, pressed and welded door jambs ensure long-term stability and durability, maintaining the appearance and performance for years after installation.



SENTRY® 200.80

- » Multipurpose
- » 3-sided jamb
- » Suits multiple wall types



SENTRY® 200.TP

- » Ideal retrofit solution
- » 3 & 4-sided external door jamb
- » No external fixings

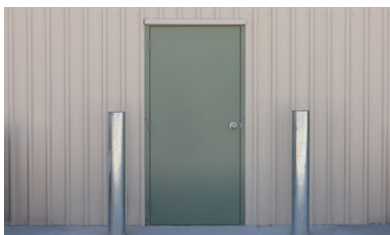

SENTRY® 200.47

- » Universal handing
- » 4-sided jamb
- » Escape function compliant

200.80 FIXING OPTIONS

NO FIXINGS



Precast into concrete wall panel

FASTFIX



Steel or timber stud

STUD CLIPS



Steel or timber stud

10MM TUBEFIX



Steel stud or concrete panel

5MM SCREWFIX



Steel or timber stud

10MM TUBEFIX



For retrofit into precast concrete wall panel

PRODUCT FILE CODE	DOOR SIZE (H x W x D)
200.80.820	2040 x 820 x 37
200.80.920	2040 x 920 x 37
200.80.1100	2040 x 1100 x 37
200.TP.820	2040 x 820 x 37
200.TP.920	2040 x 920 x 37
200.TP.1100	2040 x 1100 x 37
200.47.820	2040 x 820 x 37
200.47.920	2040 x 920 x 37
200.47.1100	2040 x 1100 x 37

3-Sided, Double and High options also available.



CONFIGURATION OPTIONS

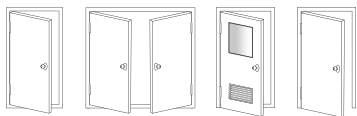

STRUCTURE

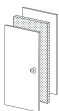

ATTRIBUTES



SENTRY™ 100 SOLID CORE RANGE 100.80 / 100.TP / 100.47

THE MARKET LEADING PRE-HUNG, FULLY METAL CLAD, SOLID CORE COMMERCIAL DOOR FOR WAREHOUSES, FACTORIES & STEEL OR CONCRETE BUILDINGS.

Compatible with all leading hardware suppliers and configurable with a range of options and upgrades, the **Sentry® 100 series** doors are the perfect total solution for warehouses, factories and transport & logistics facilities where greater security is required.

All doors in this series are manufactured with a solid timber core, wrapped in dual skin **Colorbond®** or **Zincanneal®** steel sheeting for added strength and security.

The multi-folded, pressed and welded door jambs ensure long-term stability and durability, maintaining the appearance and performance for years after installation.



SENTRY® 100.80

- » Multipurpose
- » 3-sided Jamb
- » Suits multiple wall types



SENTRY® 100.TP

- » Ideal retro fit solution
- » 3 & 4-Sided external door jamb
- » No external fixings



SENTRY® 100.47

- » Escape function compliant
- » Suitable for retro fit solution
- » 3 & 4-Sided external door jamb

100.80 FIXING OPTIONS

NO FIXINGS



Precast into concrete wall panel

FASTFIX



Steel or timber stud

STUD CLIPS



Steel or timber stud

10MM TUBEFIX



Steel stud or concrete panel

5MM SCREWFIX



Steel or timber stud

10MM TUBEFIX



For retrofit into precast concrete wall panel

PRODUCT FILE CODE	DOOR SIZE (H x W x D)
100.80.820	2040 x 820 x 37
100.80.920	2040 x 920 x 37
100.80.1100	2040 x 1100 x 37
100.TP.820	2040 x 820 x 37
100.TP.920	2040 x 920 x 37
100.TP.1100	2040 x 1100 x 37
100.47.820	2040 x 820 x 37
100.47.920	2040 x 920 x 37
100.47.1100	2040 x 1100 x 37

3-Sided, Double and High options also available.



CONFIGURATION OPTIONS

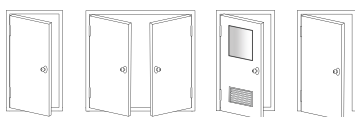

STRUCTURE



ATTRIBUTES



VENTTEC™ WALL VENTS & HATCHES VFWV / VWH.820

VENTTEC™ EXTERNAL WALL VENTS ARE ATTRACTIVE, EASY TO INSTALL AND SUITABLE FOR SUPPLY, RELIEF AND EXHAUST APPLICATIONS. IDEAL FOR INDUSTRIAL & COMMERCIAL STRUCTURES.

Venttec® Wall Vents are a cost effective solution to promote airflow and improve ventilation in your structure, providing a healthier and cleaner environment within.

Manufactured to minimise water and pest penetration, the fixed and louvered **Colorbond®** steel-pressed blades are framed in rolled steel and fastened with colour matched steel rivets, reinforced by your choice of either bird or insect mesh rear-mounted to the frame.

With standard and custom sizes available, our vents can be easily installed flat or at the cladding peak to cover an opening for an attractive finish to your air flow arrangement.

When you need an access point but not a door, our **Venttec® Wall Hatches** offer a secure and attractive option to suit your needs. Tough and lockable, **Venttec® Wall Hatches** come fitted with padbolts at the rear of each bottom corner and are supplied with gas struts, making opening and holding the hatch open a breeze.



VENTTEC® VFWV

- » External flange for face fixing
- » Bird or insect mesh available
- » Easy to install



VENTTEC® VWH.820

- » Pre-hung
- » Gas struts as standard
- » Padbolts fitted

PRODUCT FILE CODE	VENT/HATCH SIZE (H x W x D)
VFWV.66BM	600 x 600 x 75
VFWV.612BM	600 x 1200 x 75
VFWV.1212BM	1200 x 1200 x 75
VFWV.99BM	900 x 900 x 75
VFWV.912BM	900 x 1200 x 75
VFWV.66IM	600 x 600 x 75
VFWV.612IM	600 x 1200 x 75
VFWV.1212IM	1200 x 1200 x 75
VFWV.99IM	900 x 900 x 75
VFWV.912IM	900 x 1200 x 75
VWH.820	820 x 2040 x 35



CONFIGURATION OPTIONS

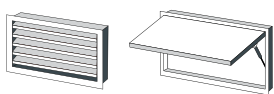

SUPPLIED HARDWARE

A COMPREHENSIVE RANGE OF DOOR HARDWARE SOURCED FROM TRUSTED MANUFACTURERS IN AUSTRALIA AND AROUND THE WORLD.

For high use doors, only commercial grade hardware will suffice. We have decades of experience in working with leading manufacturers and distributors of door hardware – and with a large range of upgrade options available:

- » Door Closers
- » Latch Guards
- » Spring Chain Retainers
- » Kick Plates
- » Door Seals
- » Exit Devices (Panic Bars, Crash Bars)

MORTICE LOCKS

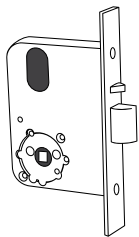

For added security and peace of mind, we offer both a standard mortice lock, with a keyed deadbolt mechanism, and an electric mortice lock, including Cable transfer passage prep.

Lockwood Mortice Locks are made from quality materials and suitable for heavy duty use in industrial and commercial buildings, storerooms, schools, sporting facilities, hotels, and similar buildings, where the need for added strength and security is critical.

DOOR CLOSERS

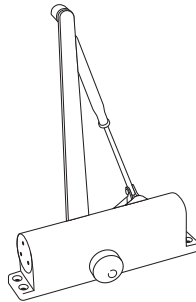

With a stylish silver finish and universal fixing pack for push or pull side mounting, Ryobi's dual handed surface-mounted door closers are easy to install and provide for the controlled closing of doors from 65kg – 80kg in weight.

The speed at which it closes the door can be adjusted, controlling the sweep speed and the latch speed of the door for a perfect closing action.

PANIC BARS

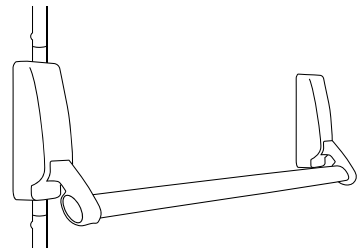

Panic bars are designed to provide building occupants fast and easy egress in an emergency.

The Briton 376 Series is designed to provide immediate escape and incorporates all the features and benefits expected from an exit device that is branded Briton.



Note: Accessories may vary.

LARNEC USES LEADING HARDWARE BRANDS



Briton



LARNEC.COM.AU



1800 527 632

20 Mallett Road,
Tullamarine. Victoria. 3043

1-3 Shepherd Road,
Swan Hill. Victoria. 3585

Level 2, 8-12 King Street,
Rockdale. New South Wales. 2216

LARNEC.COM.AU

